



DRAENERT



**MONTAGE
ASSEMBLY**

1280-II ATLAS

ASSEMBLY

1280-II ATLAS - FOR STONE AND WOOD

CONTENT OF THE DELIVERY

(remains with the customer)

- 1 pedestal
- 1 main table top
- 1 extension top
- 4 countersunk screws M6 x 18 mm
- 4 cylinder head screws M8 x 20 mm
- 1 sliding pin
- 1 safety splint pin
- 3 plastic slip washers
- material information
- care product



ASSEMBLY VIDEO

PERSONS REQUIRED FOR ASSEMBLY:

4 PERSONS FOR THE STONE TABLE / 2 PERSONS FOR THE WOOD TABLE

- 1 |** The table is completely pre-assembled, a subsequent adjustment is in general not necessary. Unpack the pedestal with the pre-mounted swivelling frame and place it at its required location. Check the correct position of the pedestal. The frame must stand on all 4 glides and should not wobble. If necessary the fixing screws of the side walls can be slightly be loosened and again be tightened, so that the pedestal can set on the floor.

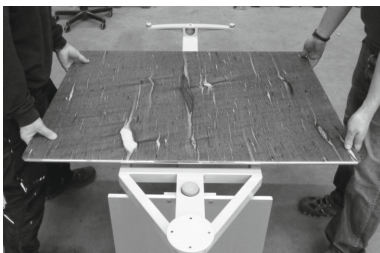
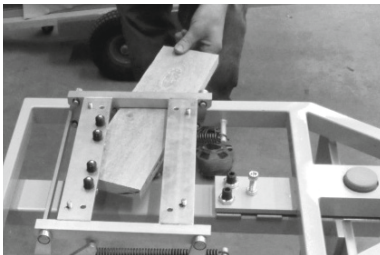

- 2 |** Remove now carefully the transport lock between the swivelling frame and the support bars of the extension top. Please pay attention that the rollers of the guide bracket remain under the support bars in their locking position.

ATTENTION the swivelling frame remains in the closed position. Furthermore you have to pay attention, that the support bars of the extension top are adjusted in the upper position.

- 3 |** Put the extension top carefully as per the coloured marks on the swivelling frame.

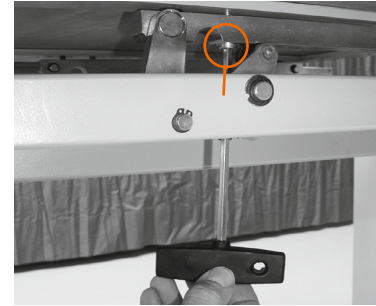

- 4 |** Feed the included cylinder head screws M8 x 20 mm from the underside through the holding frame into the glued subframe at the slewing ring of the extension top, in order to fix the plate. (fix only slightly, do not yet tighten it)

ATTENTION Before starting the **next step** of the assembly, you have to pay attention that the extension top is in the lower position; as otherwise, the tops could get damaged, respectively scratched, when the assembly will be continued.

Pull the extension top with a little force out of its locking in direction towards the centre of the table. The plate goes down than with a circular movement, until the extension top lies completely on the extension frame.

The extension top must always remain closed during the assembly in order to avoid tilting of the whole table.



- 5 |** Feed now the sliding pin into the glued frame of the main top. Pay attention that on each point of contact, there is a plastic washer.

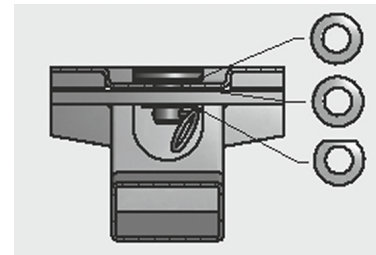

- 6 |** The plastic washer with the chamfered surface has to be used with the safety splint pin in the main tube (please see schematic view).



- 7 |** Put the main top with the round support part underneath, showing towards the extension top and thus to the pivoting point on the pedestal. Please pay attention that the round support part feeds into the round turned part of the extension frame.



- 8 |** In order to feed the sliding pin into the mouth of the cross beam, lift with two persons the main plate on the rear side and push the sliding pin with a sliding washer along the notch, until it is congruent with the drilled hole at the cross beam and let the main table top down very carefully.

ATTENTION Danger of squashing the fingers when lowering the table top on the cross beam!

Secure the sliding pin with the chamfered slip washer and the security splint pin in the main tube under the table.

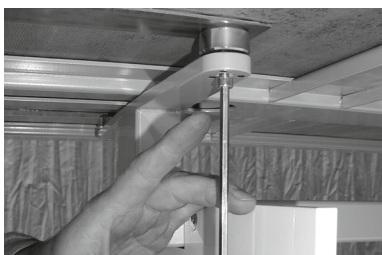

- 9 |** In case the security splint of the sliding pin may not be inserted, remove one of the two sliding washers, in order to achieve more space to secure the sliding pin with the cotter splint. Afterwards the sliding washer must again be assembled.

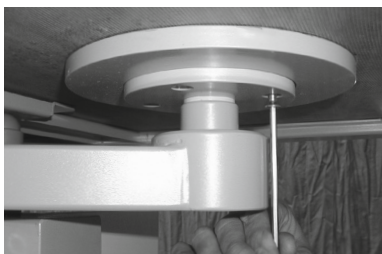

- 10 |** Fasten the main table top at the fulcrum with the round support part by the attached countersunk screws M6 x 18 mm, by turning the support part congruently to the drilling wholes. Screw-in the four screws and tighten them firmly.

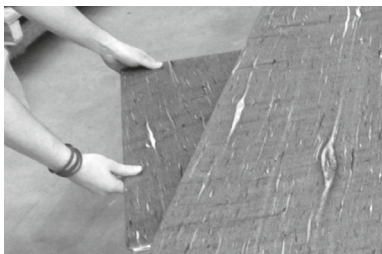

- 11 |** Swing out completely counter clockwise the extension top to the left side from its locking, until it will align with the main table top. Lift the extension top carefully, until it aligns closely with the plastic strip at the main table top.

- 12 |** Move the extension top by slight pushing and lifting to the main table top and hold it, while a second person fixes the screws of the extension top from the underside.

ATTENTION Do not fix the screws too much; a hand-tightening with a T-key is sufficient. The space of the gap between the two table tops should be even. Also the two table tops should have the same height.

Now the table is ready assembled.

OPERATION

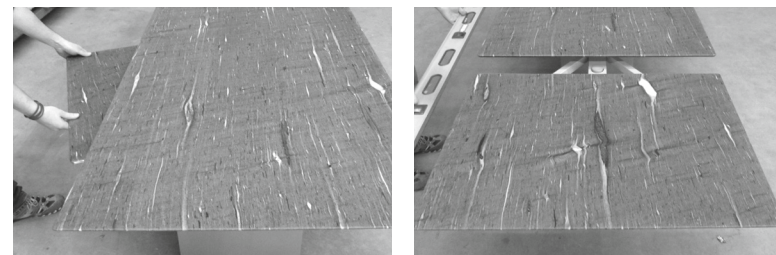

Turn the extension top under the table by 90° counter clockwise. Loosen the extension top from its locking under the main table top, by turning the extension top with a circular motion counter clockwise to the operating side (side wall with the Draenert Logo).

Pull out the extension top until it will align with the main top. Raise the extension top carefully until it is positioned with its plastic stripe at the main table top. The extension top locks automatically. Make sure that you do not lift the top too diagonally towards the main top, as than the two table tops may touch each other and could break.

In order to close the table, loosen the extension top from its locking by pulling it with a little force to oneself. The extension top then makes a circular motion until it rests on the swivelling frame.

ATTENTION The extension top must rest completely on the frame as otherwise the tops may collide when the table will be closed!

Turn in the extension top clockwise under the main table top until it is locked. Then turn the table top again by 90° clockwise, in order to let disappear the edges under the main table top.

NOTE The table can be closed from the operating side (side wall with Draenert logo) to the left side clockwise. For opening of the table please proceed in reverse order.

Further information on the back side.

PFLEGE

Der Tisch und seine Schwenkmechanik sind wartungsfrei. Zur Pflege der jeweiligen Plattenart beachten Sie bitte die entsprechende Materialinformation.

STANDORTWECHSEL

Beim Standortwechsel eines komplett montierten Tisches niemals am überstehenden Plattenrand tragen. Bei Steinplatten besteht die Gefahr des Plattenbruches.

Verwenden Sie hierzu Tragehölzer, die unter den Unterkleberahmen der Hauptplatte fassen. Tisch nur im eingeschwenkten Zustand anheben, niemals an der Schwenkplatte anheben.

UMZUG

Demontieren Sie den Tisch in umgekehrter Reihenfolge. Die Platten müssen separat vom Unterbau transportiert werden.

Achten Sie darauf, dass die einzelnen Platten immer nur stehend mit entsprechendem Kantenschutz transportiert werden. Liegender Transport führt zum Plattenbruch!

CARE

The table and its mechanism are maintenance-free. In regard to the care of each individual table top, please read the according material information.

INSTRUCTIONS FOR MOVING THE TABLE

In case you like to move the completely assembled table, never carry it only at the edges of the main plate. Especially stone tops may break.

Please use wooden carrying bars, which are must be put under the frame of the main plate. Please lift the table only in closed condition and never lift it on the extension plate.

REMOVAL

Disassemble the table in reverse order. The table tops must be moved separately from the pedestal.

Take care, to transport the table tops only in upright position with a sufficient edge protection. Horizontal transport leads to the breakage of the table tops!

DRAENERT GMBH

STEIGWIESEN 3
88090 IMMENSTAAD/BODENSEE
GERMANY

FON +49 (0) 7545 - 2080

info@draenert.de

www.draenert.de

FOLLOW US

